



Access
the
inaccessible®



ACCESSBOOK n°1

Belaying in a climbing gym

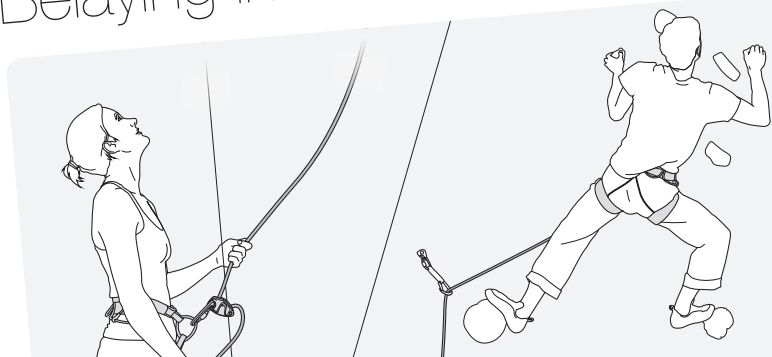



© 2022-Petzl Distribution-LAFOUCHE

Access the inaccessible. You have dreams and our mission is to help you realize them to the fullest extent possible.

Petzl's ACCESS BOOK booklets are designed to go with you as you prepare for and achieve your goals as a mountaineer, climber, skier... Each ACCESS BOOK covers one particular activity. It is a collection of selected technical tips from Petzl.com

This first booklet is dedicated to gym climbing, for learning and/or reviewing the basics of top-rope or lead climbing.

Put on your shoes, and good climbing!

Warnings:

- These booklets present an excerpt from the body of techniques for the activity.
- Get training and practice in the techniques of the activity.
- You must read, understand and follow the Instructions for Use of the products associated with the proposed techniques.
- The environment and the activity itself are inherently dangerous. You are responsible for your own actions, decisions and safety.

Contents

PREPARATION Harness attachment points	2
PREPARATION Tying in with a figure-eight knot	3
PREPARATION Partner check	4
BASICS OF BELAYING Belaying a climber on top rope	6
BASICS OF BELAYING Belaying a climber on lead	10
BASICS OF BELAYING Lowering	14
LEAD CLIMBING Clipping	16
LEAD CLIMBING Errors to avoid	18
CLIMBING WITH AN AUTO BELAY SYSTEM Inspection points	20

PREPARATION

Harness attachment points

Harness with one attachment point

Attachment point

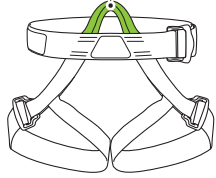

Rope attachment point

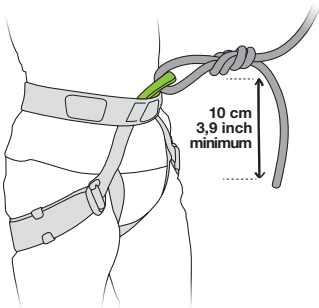

Attachment point
Belay system

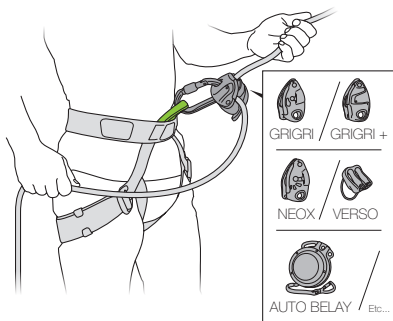

Harness with a belay loop and two tie-in points

Belay loop

Two tie-in points

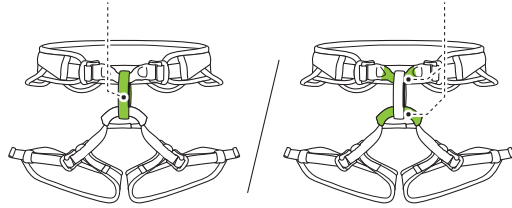

Rope attachment point

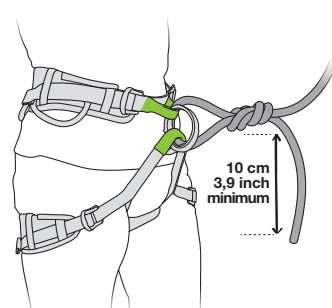

Belay system
Attachment point

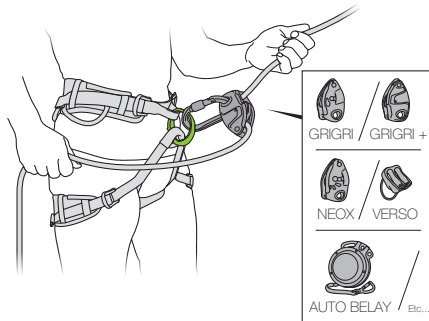

PREPARATION

Tying in with a figure-eight knot

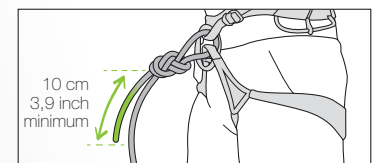
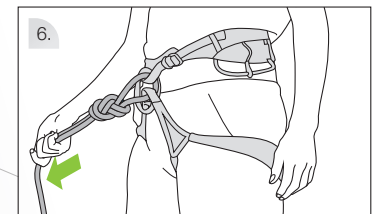
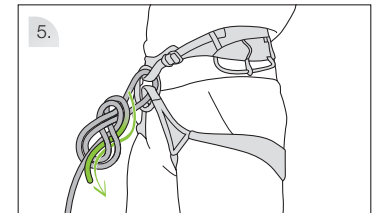
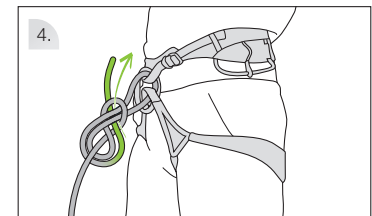
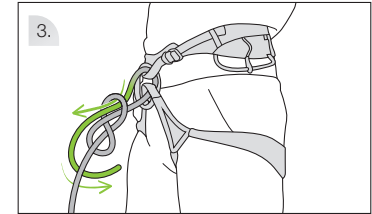
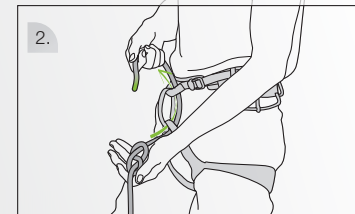
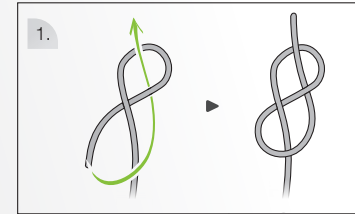

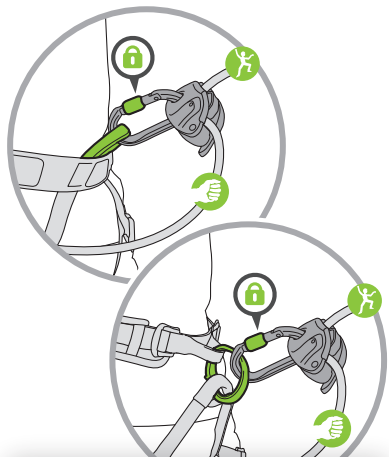

Belay system setup

- Rope installed in the proper direction (belay device function check)
- Carabiner connected to the harness attachment point
- Carabiner is locked

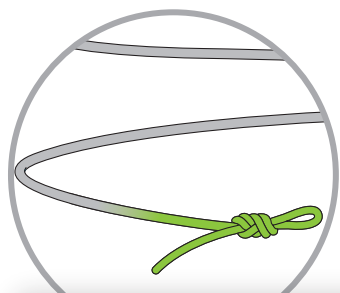

Rope

- Knot tied at the end of rope

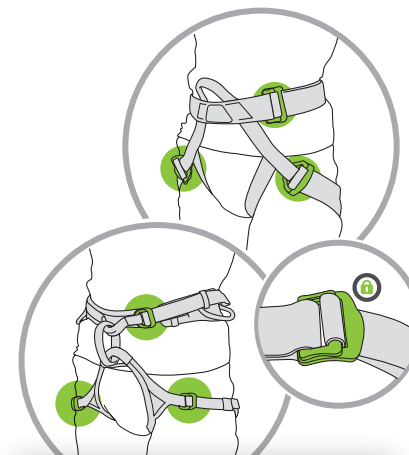
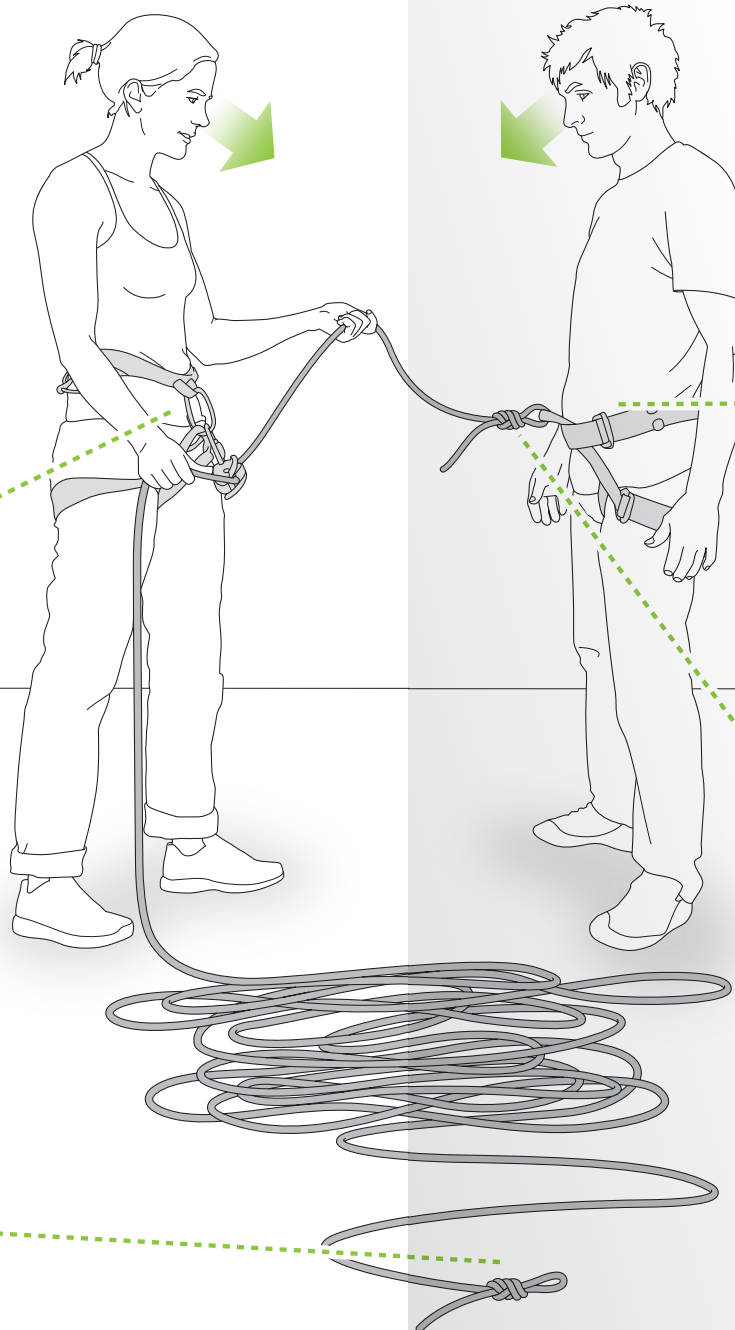

Harness

- Harness waistbelt positioned directly above the hips
- Harness adjusted to fit snugly
- Proper tightening and fastening of the adjustment buckles

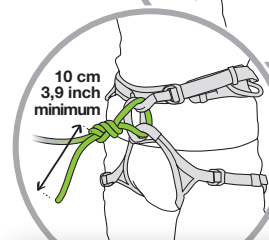
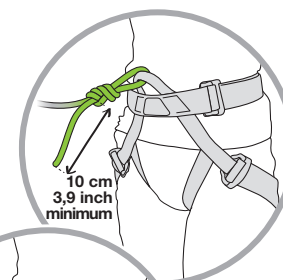

Tie-in knot

- Tie in to the harness tie-in points
- The correct knot
- Well-tightened knot with at least 10 cm of tail

BASICS OF BELAYING

Belaying a climber on top rope

Top rope with rope in place

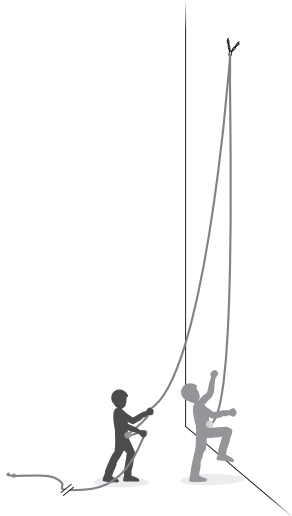

Installing a top rope at the belay anchor

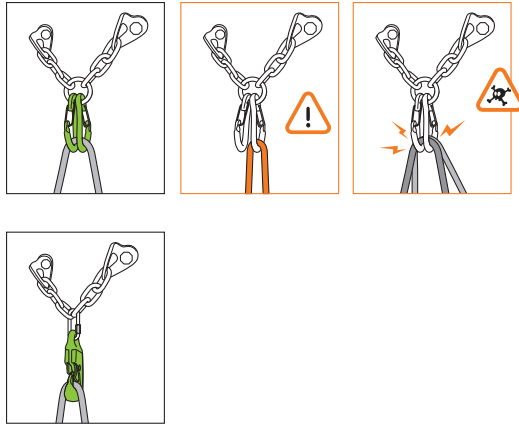

Overhangs, climb on the rope clipped to the quickdraws

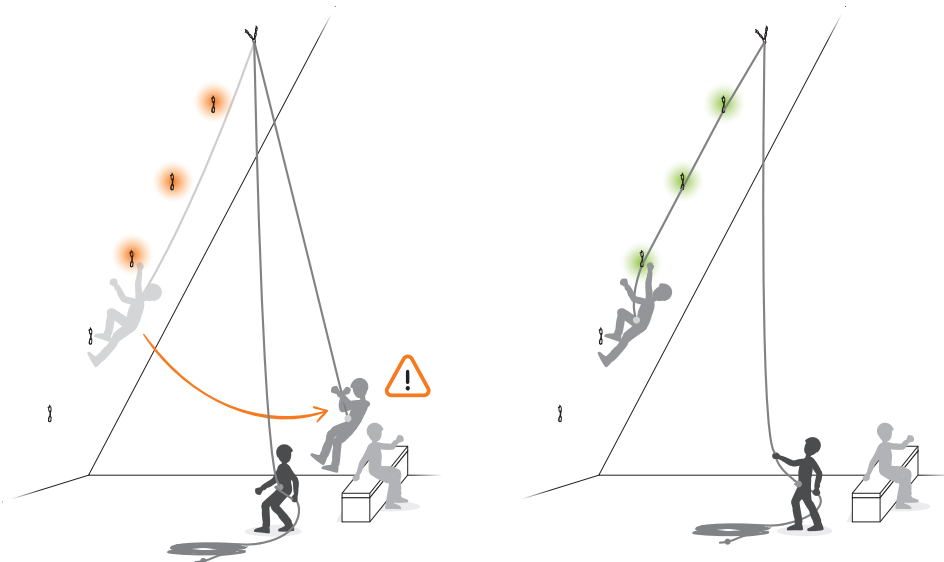

BASICS OF BELAYING

Belaying a climber on top rope

Primary belaying position

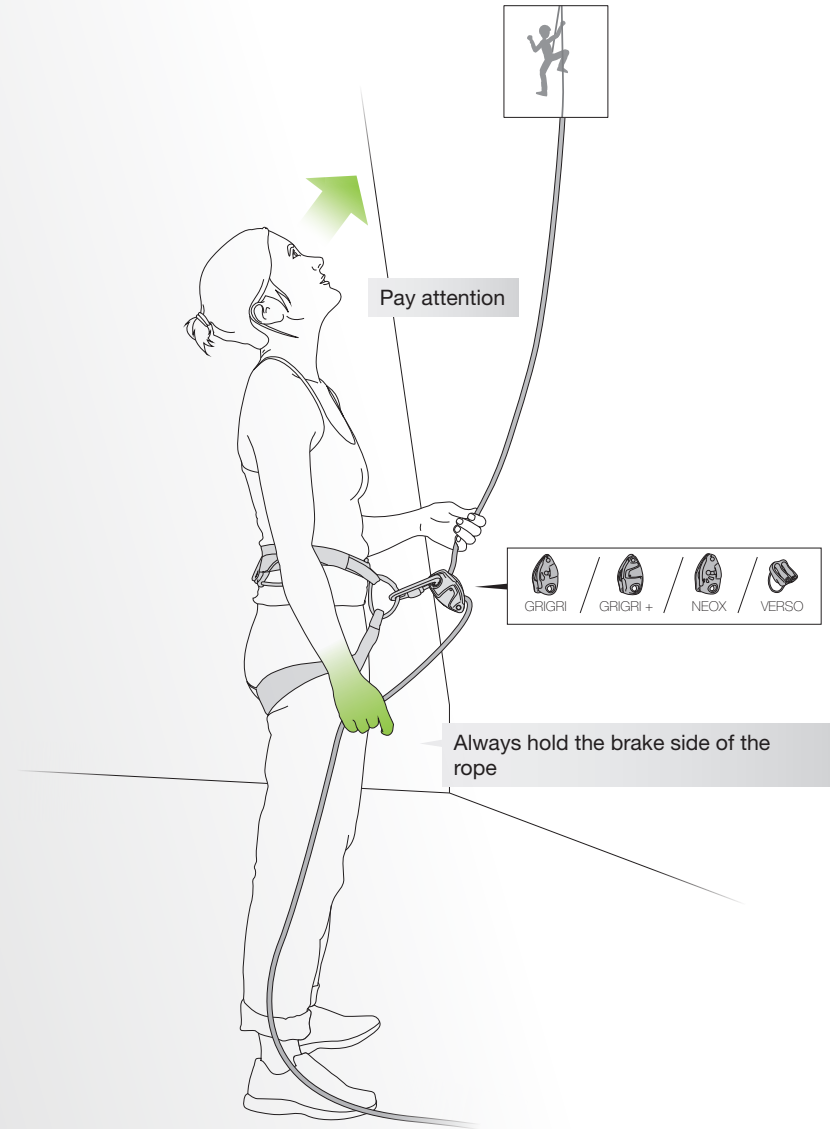

Belaying a climber on top rope

Technique: taking up slack

Technique 1

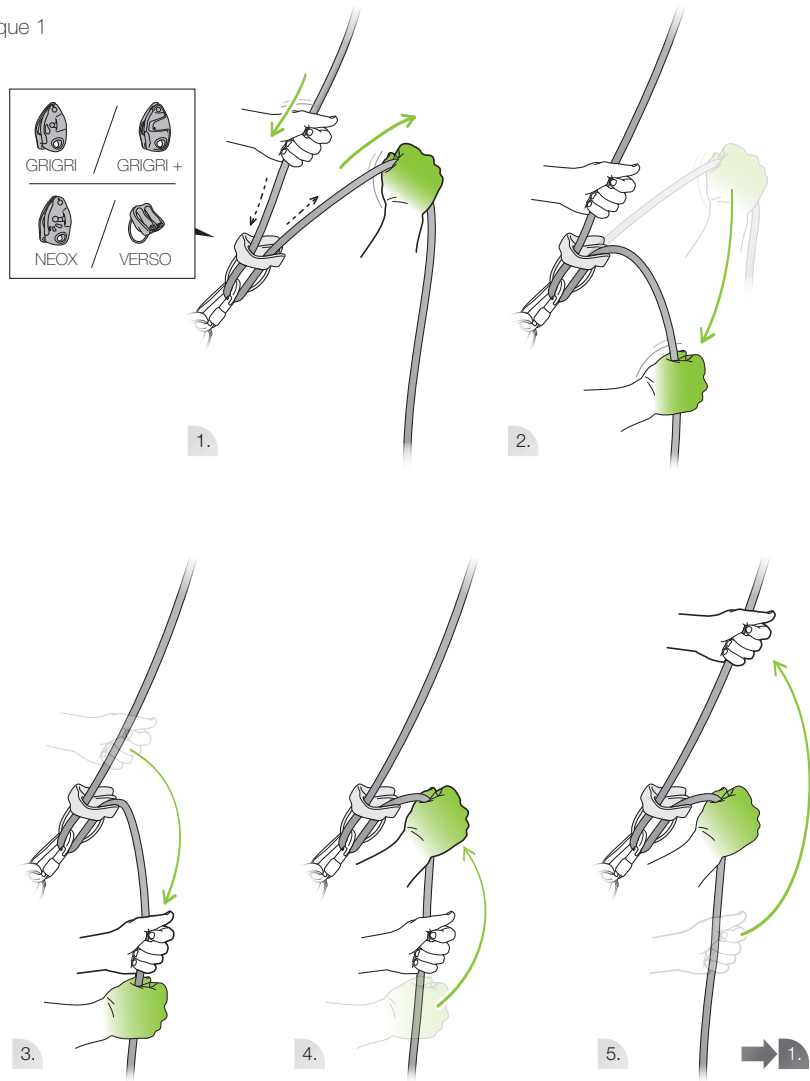

Alternative technique available at Petzl.com

Belaying a climber on top rope

Technique 2

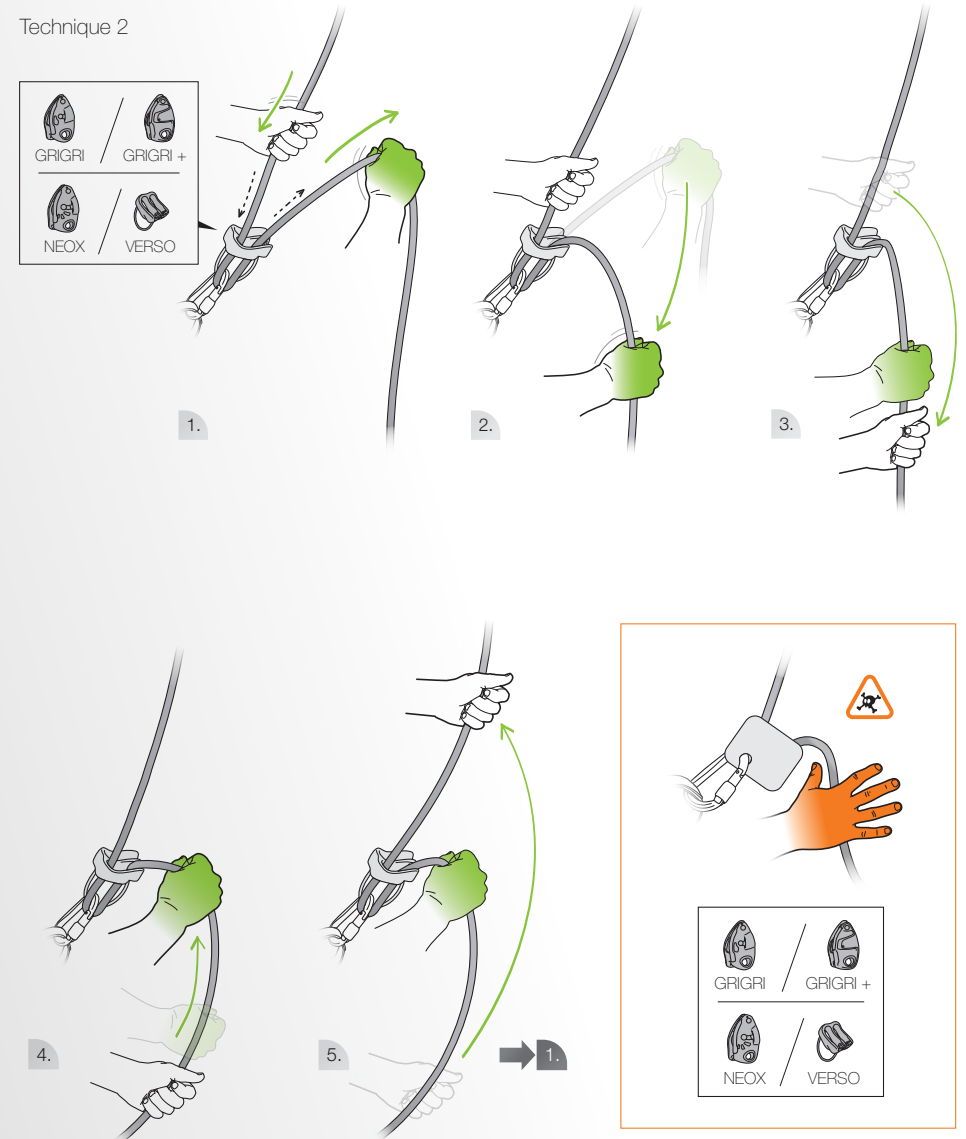

Belaying a climber on lead

Spotting the climber at the start of the route

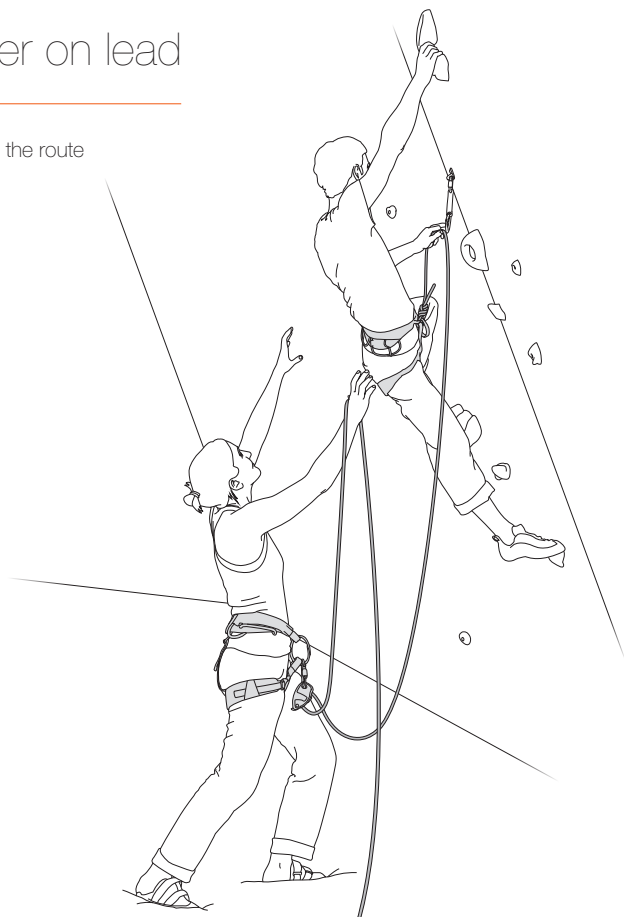

Spot until the first point is clipped

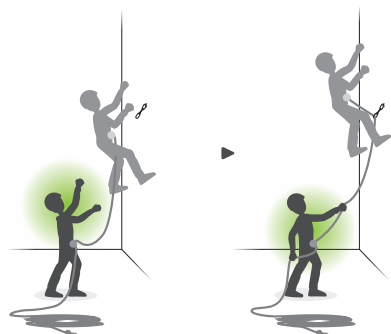

Be alert and mobile for the first points

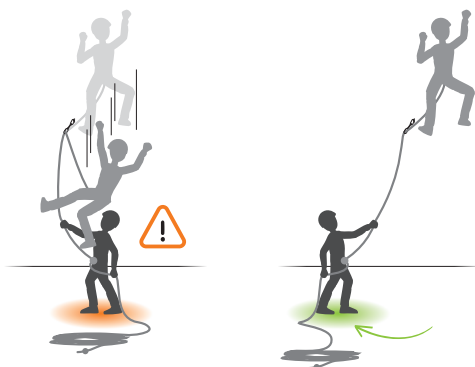

Belaying a climber on lead

Primary belaying position

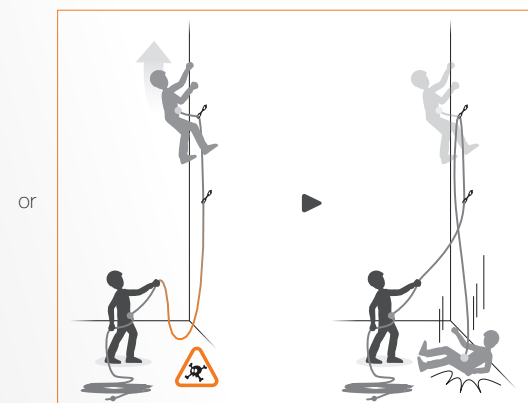
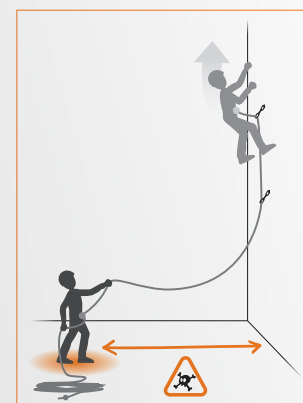
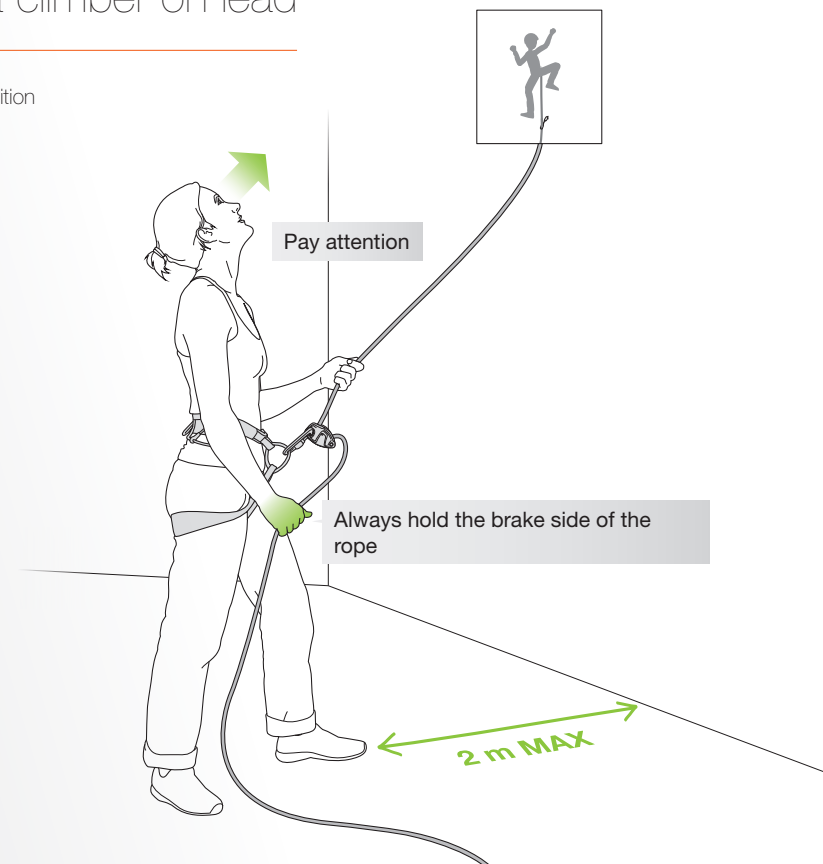

BASICS OF BELAYING

Belaying a climber on lead

Technique: giving slack

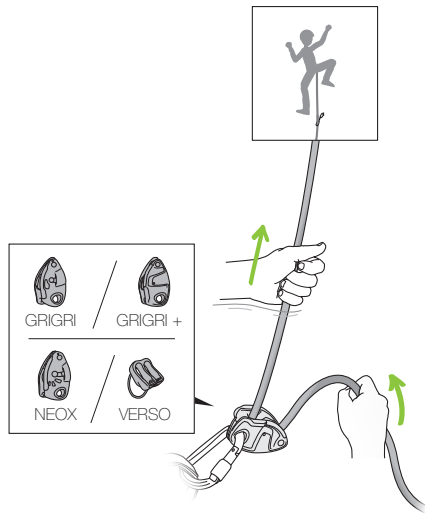

Technique: taking up slack

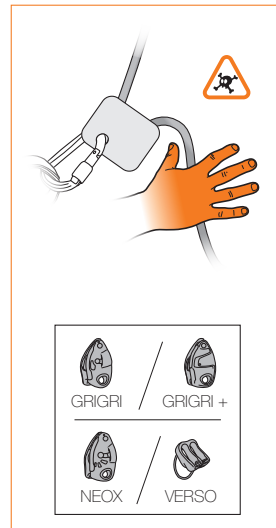
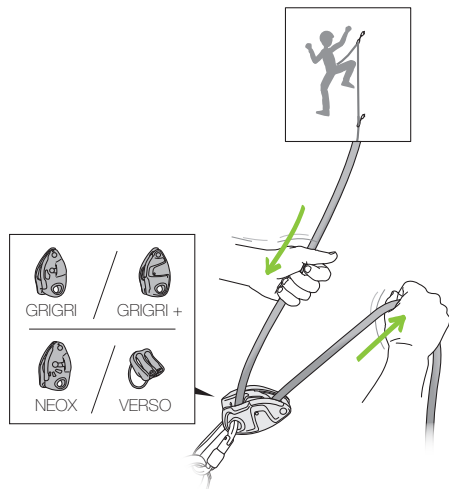

BASICS OF BELAYING

Belaying a climber on lead

Technique: holding a fall

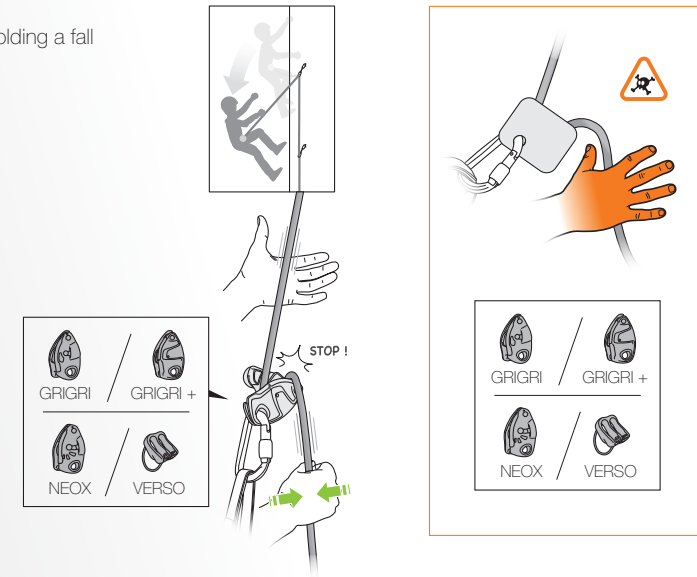

For a dynamic belay, do a small jump or take a step forward to reduce the impact force on the climber

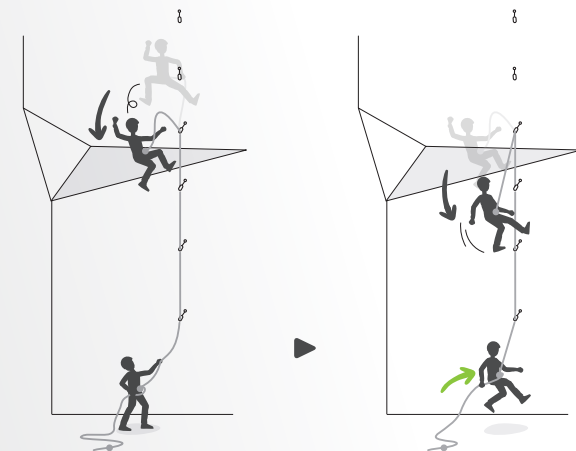

Lowering

Communication before lowering

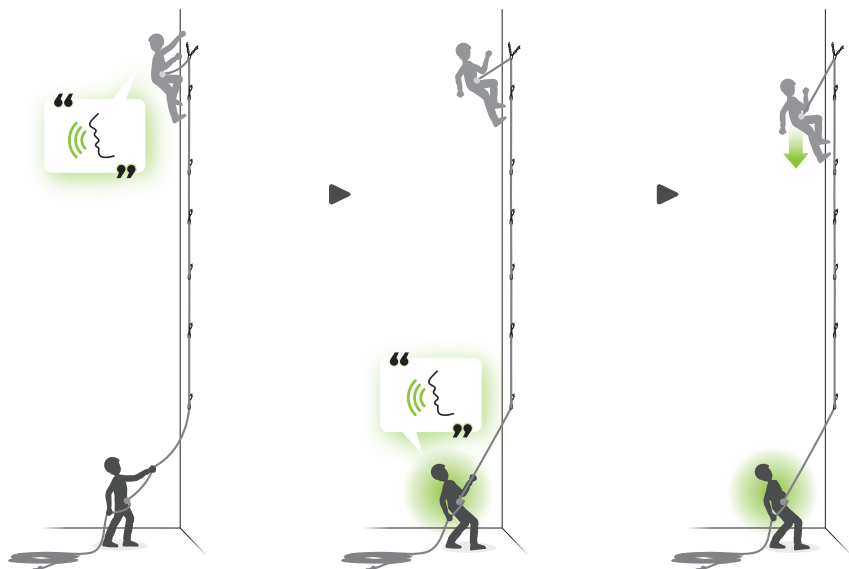

© Petzl / Petzl Distribution - vuedici

Lowering

Technique: lowering

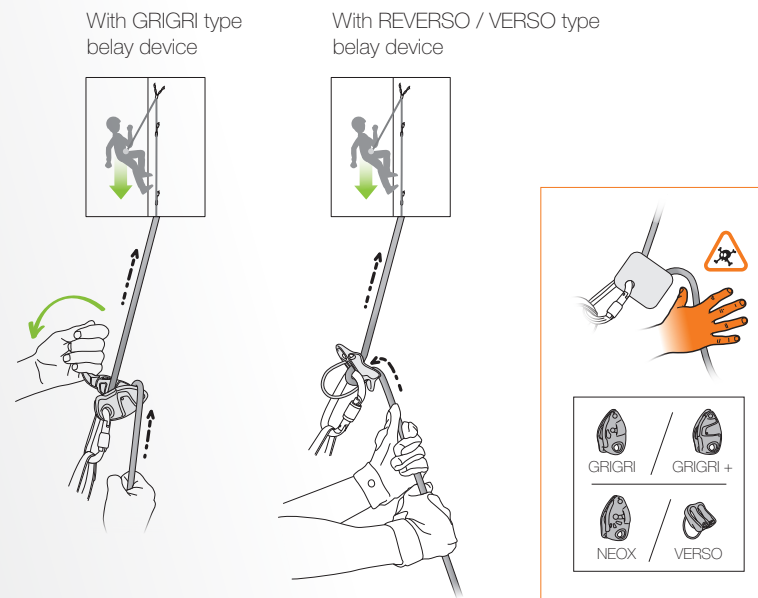

Be alert when nearing the ground

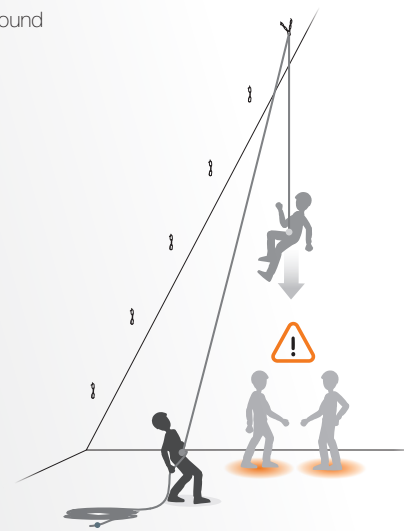

LEAD CLIMBING Clipping

Clipping at waist level

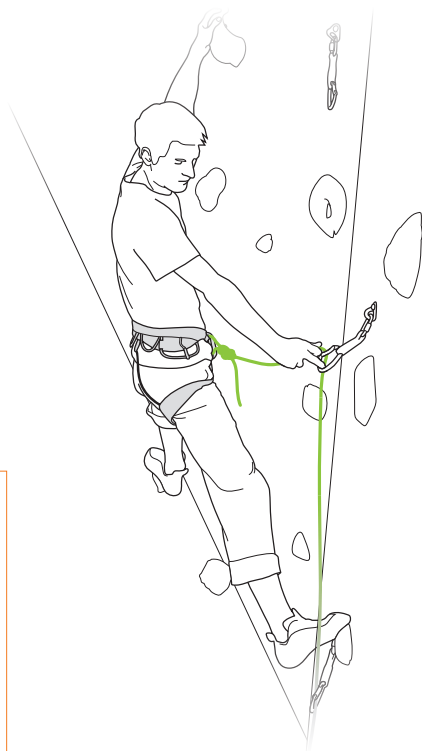
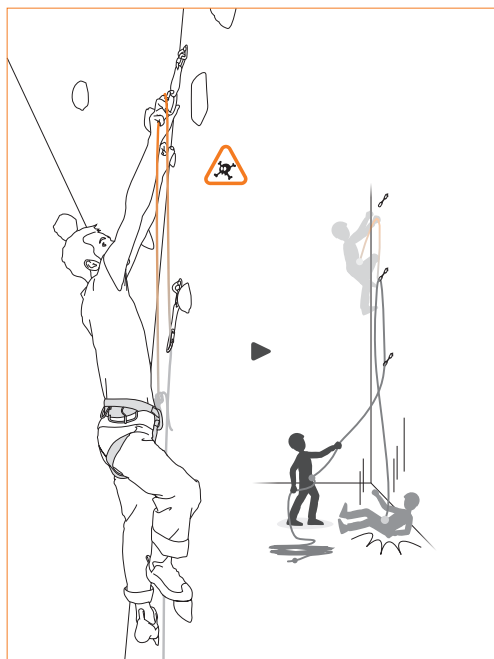

LEAD CLIMBING Clipping

The most common clipping techniques (other techniques exist)

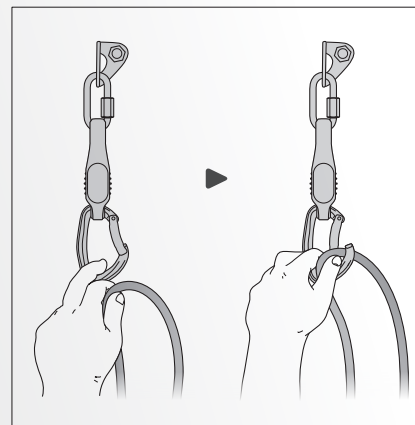

or

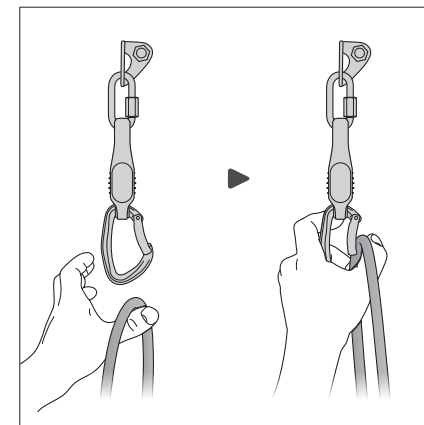

Rope properly clipped to the quickdraw

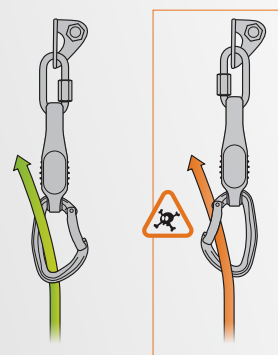

Errors to avoid

Rope behind leg

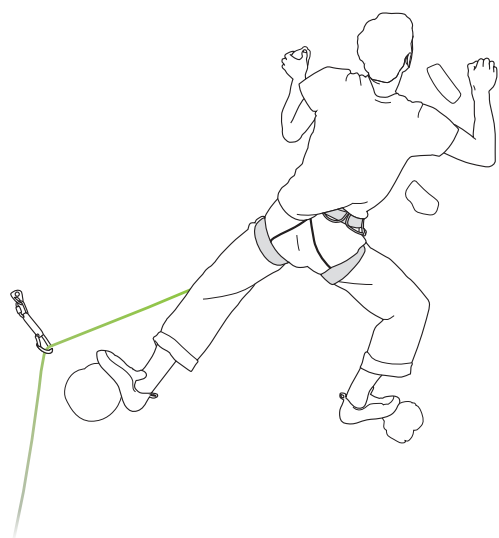
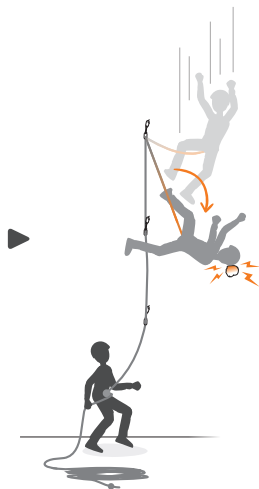
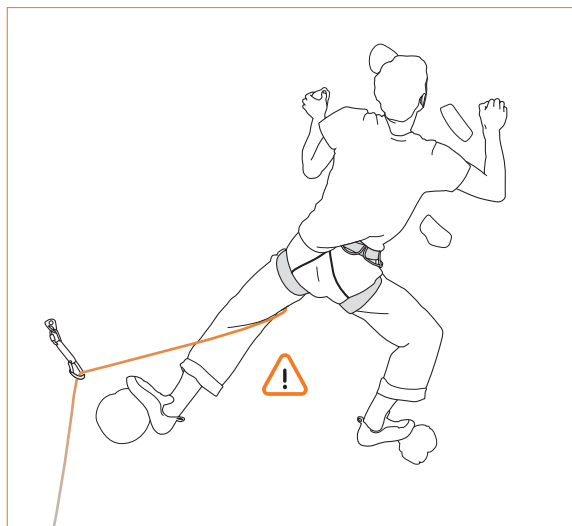

Errors to avoid

Do not grab a quickdraw when falling

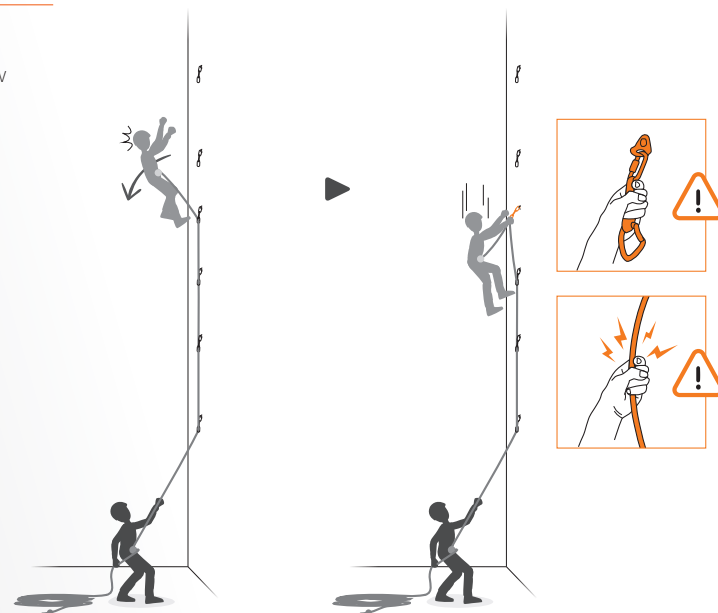

Do not skip a quickdraw

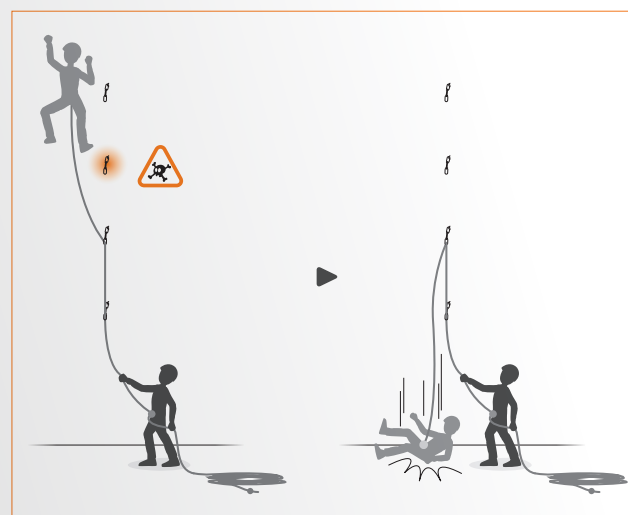

Do not Z-clip: take the rope on the correct side of the quickdraw

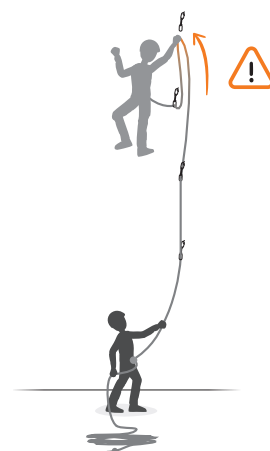

Inspection points

You must be trained and accredited before using an auto belay system

Points to verify

Visual inspection

- Connector connected to the harness attachment point
- Connector locked

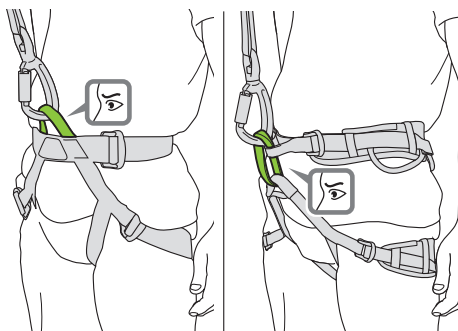
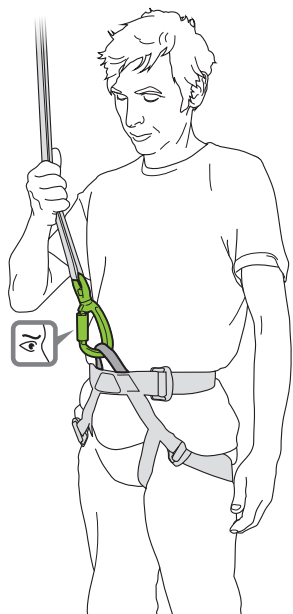

Function test

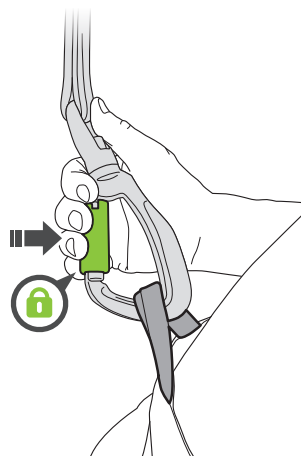
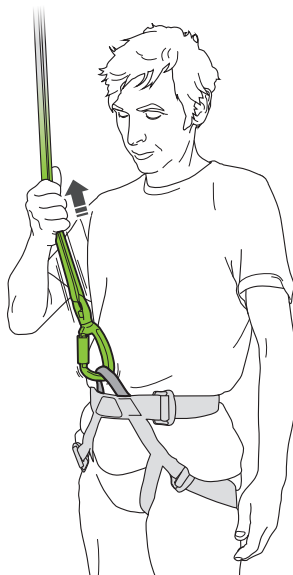

For more information

Find more technical tips and videos on sport climbing at www.petzl.com

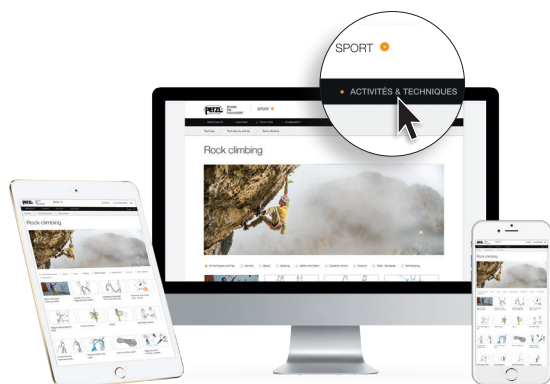

... And discover even more about the other activities in our **ACCESS BOOK** booklets.



The information contained in this brochure is non-exhaustive.
See the Instructions for Use for the products, and related
technical tips. Training is essential.
You are responsible for your own actions, decisions and safety.

© 04/2024 Petzl Distribution



Access
the
inaccessible®